

PODIUM WHEEL BASE DD1



Quick Guide

EN

Manufactured by
ENDOR®
Fanatec® is a registered trademark of Endor AG
Designed and developed by Endor AG in Germany
Seligenthaler Straße 16 a - 84034 Landshut - Germany
Telephone: +49 (871) 9221-122 Fax: +49 (871) 9221-221
Email: info.webshop@fanatec.com
Website: www.fanatec.com - www.endor.ag

12/2018



www.fanatec.com

MANUAL

This QuickGuide is only meant to outline basic functionality. Please visit www.fanatec.com/support in order to learn more about all of the features of this product. This is just a QuickGuide and you will miss a lot of features if you don't read the user manual.

This product is under warranty of Endor AG, Seligenthaler Straße 16a, 84034 Landshut, Germany,
Telephone: +49 (871) 9221-122, Fax: +49 (871) 9221-221,
Email: info.webshop@fanatec.com.
Refer to the chapter 'warranty' of the user manual as well as the terms & conditions of Endor AG on <https://www.fanatec.com>.

Please note that for this product warranty extensions are available for up to three or five years (optional).

ATTENTION

- If you have an existing Fanatec Pedal set, please replace the old RJ12 cable with the new one included (G).
- When connecting the power supply (B), please connect it to the DD Wheel Base (A) BEFORE connecting it to the power outlet/socket (C).

When starting up the Podium Wheel Base for the first time, please update the firmware. You can obtain it from www.fanatec.com/downloads. Follow the instructions provided by user manual.

Do not cover the air intake on the front side with accessories, and do not place any items in a 10cm range behind the wheel base to allow proper cooling airflow.

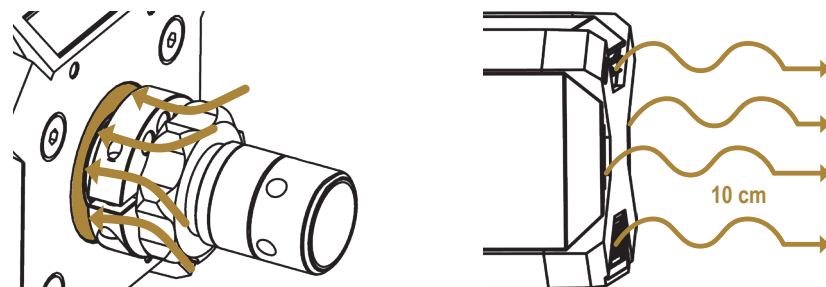

| PAGE 1 |

CONTENTS

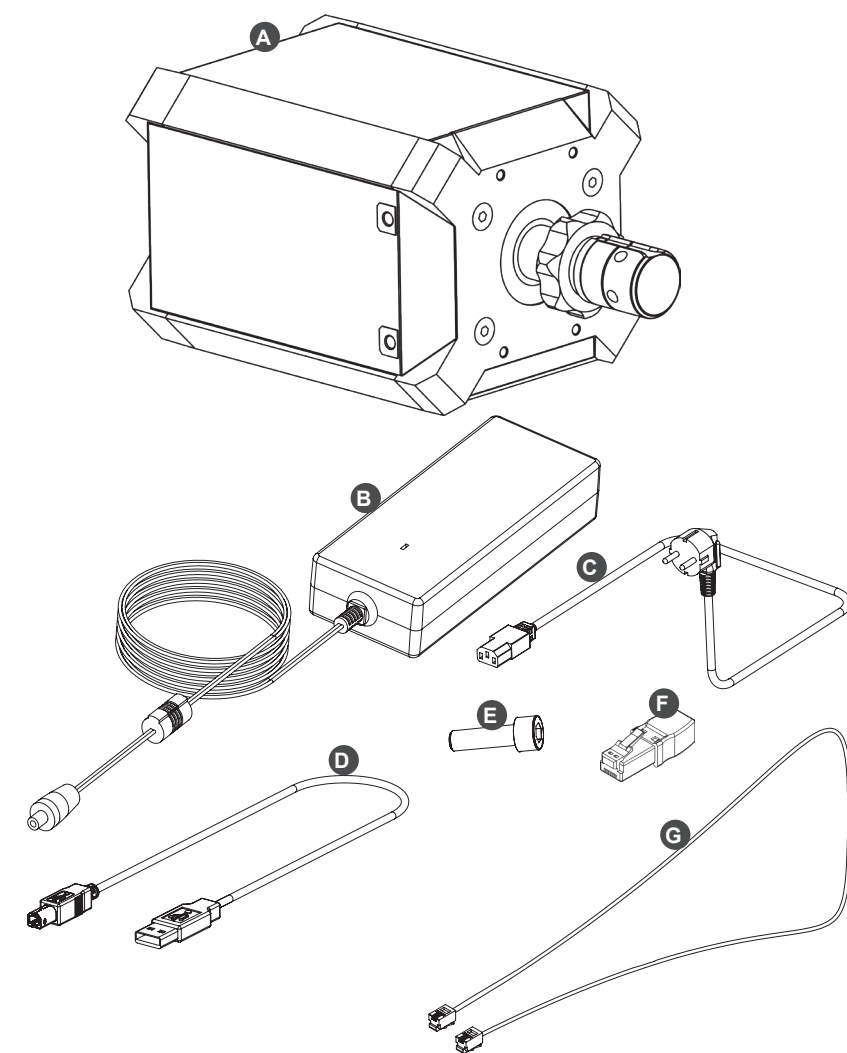

- Podium Wheel Base DD1 (A)
- Power supply unit (B)
- Power cord (regional) (C)
- USB connection cable (D)
- Cylinder head screw ISO 4762 M6x20 (only for simplified QuickRelease) (E)
- Torque Key (F)
- RJ12 connection cable for Pedals (G)

| PAGE 2 |

MOUNTING THE PODIUM WHEEL BASE

Download drilling templates from
www.fanatec.com/downloads.



SIDE MOUNTING

On both sides of the wheel base there are two M8-threaded holes:

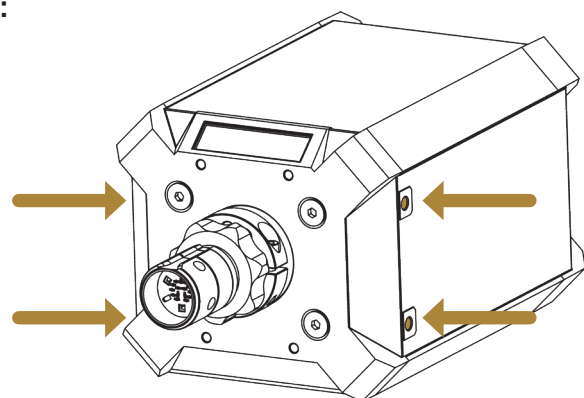

BOTTOM MOUNTING

On the bottom side of the wheel base there are five M6-threaded hole patterns for Fanatec triangular mounting and square mounting (78,4mm x 66mm):
Using the front center hole with the two rear holes (Fanatec Triangular mounting - marked with gold arrows) is sufficient for use.

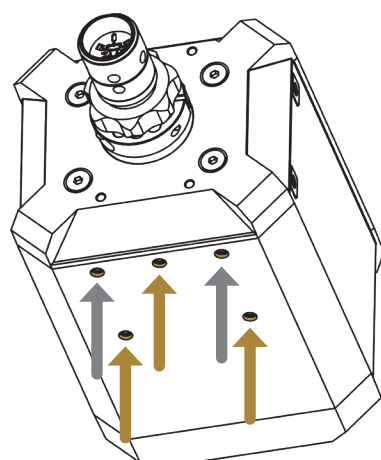

| PAGE 3 |

ATTACHING THE STEERING WHEEL

1

Turn the locking ring in a CW direction to the back of the shaft. Make sure the rubber ring is not compressed.

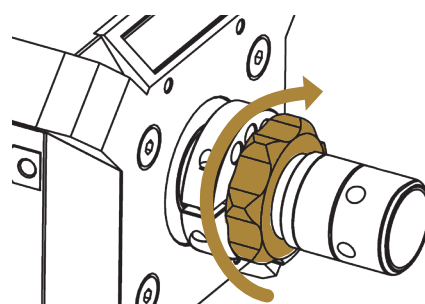

2

Rotate the shaft so the groove points to the top.

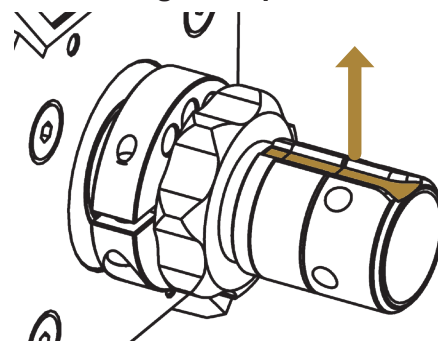

3a

Fanatec ClubSport Quick Release: Pull and hold the QuickRelease sleeve and carefully push the steering wheel onto the shaft. Release the sleeve.

When using the Fanatec ClubSport Quick Release on a Podium DD, no screw is required.

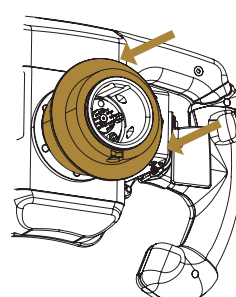

| PAGE 4 |

3b

Simplified Quick Release: carefully push the steering wheel onto the shaft. Use the M6x20 screw from the Podium Wheel Base accessories for tightening the clamping ring.

⚠ Do not use the M6x16 screw provided with your steering wheel! Replace it for the cylinder head screw (E) from Podium Wheel Base package content!

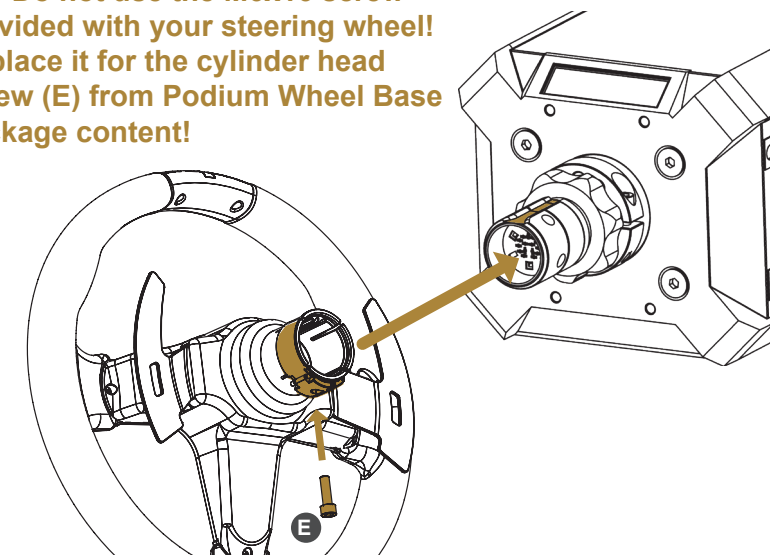

NOTE: When a simplified Quick Release is used, the wheel base automatically limits the torque to prevent damage. ClubSport Quick Releases are required to utilize full torque.

4

Turn the locking ring in a CCW direction for a tight fit.

Proceed in reverse order to remove the wheel from the base.

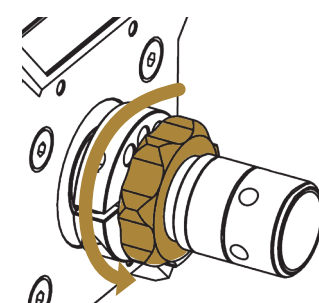

| PAGE 5 |

CONNECTIONS

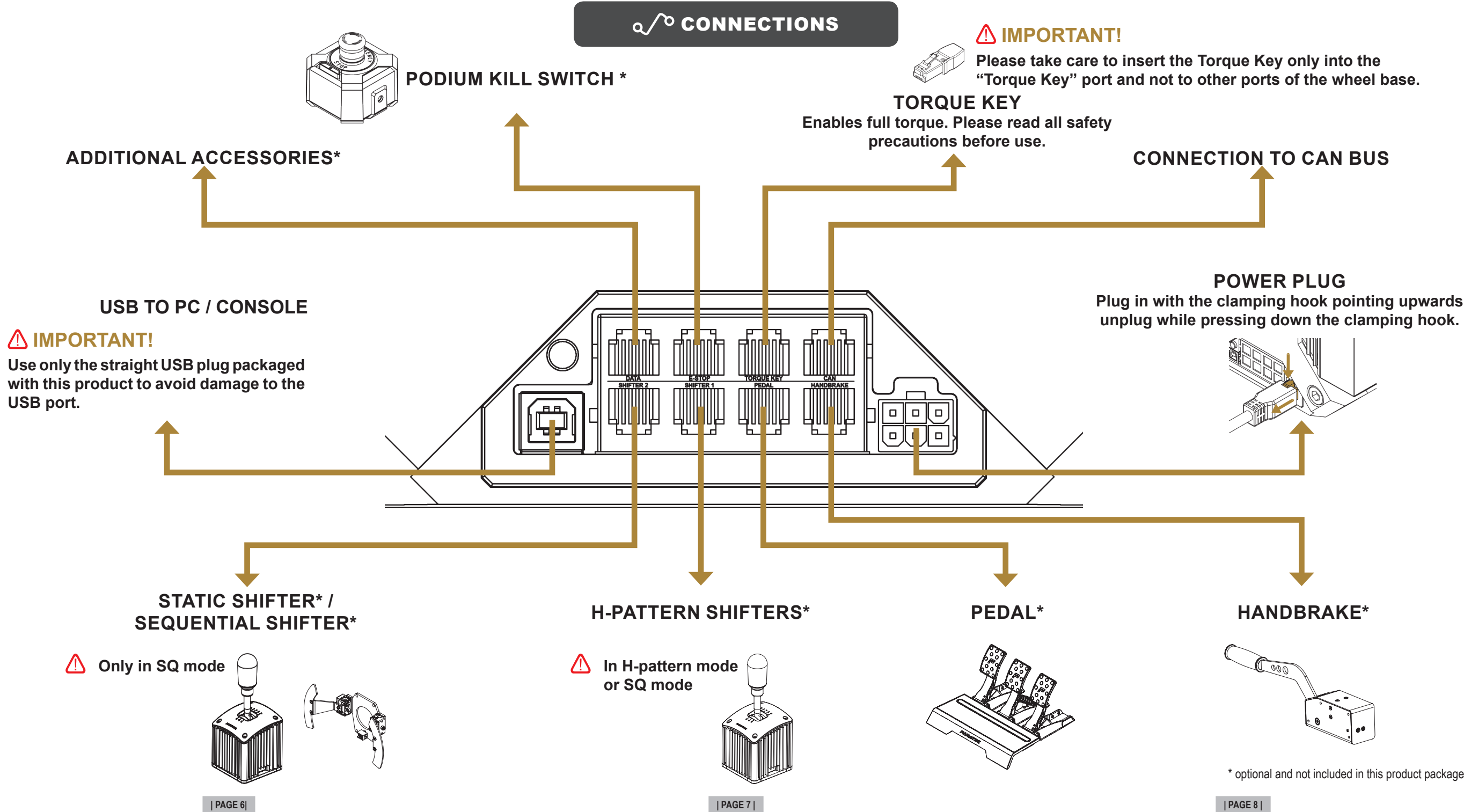

ON AND OFF

To turn on the Podium Wheel Base connect it to power and press the **POWER BUTTON** for about one second on the back side. Also the (optional) Podium Kill Switch has a power button to turn on the wheel base. To turn off press and hold the **POWER BUTTON** for 5 seconds and then release.

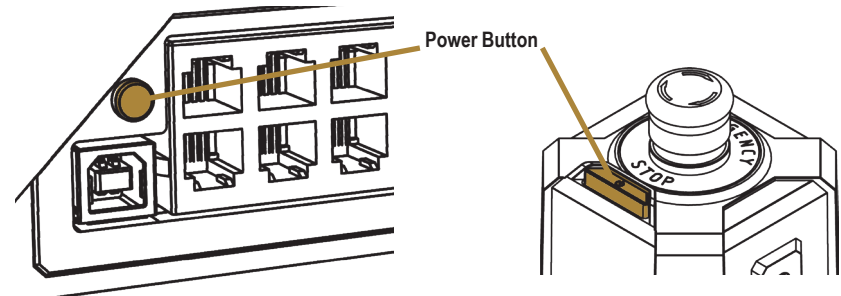

NOTE: Only use the power supply (B) and power cord (C) included with this product.

TORQUE KEY

! The Torque Key (F) unleashes the full torque of the Podium Wheel Base. You will be prompted by a safety warning before use. Due to safety reasons this Torque Key is not inserted at the factory. Please take care and read all safety warnings before inserting the Torque Key. To protect unexperienced users and children from injuries we recommend to always remove the torque key when the wheel base is not in use and/or unattended.

Please take care to insert the Torque Key only into the “Torque Key” port and not to other ports of the wheel base, or any other devices besides the Podium Wheel Base.

MODES

Each steering wheel has a different button press combination in order to change modes. Please see your wheel’s quick guide in order to see which button press combination is required.

Xbox One mode requires an Xbox One licensed Fanatec steering wheel (e.g. ClubSport Universal Hub for Xbox One or ClubSport Steering Wheel Formula V2).

The current active operation mode is indicated on the upper left corner of the wheel to base’s OLED display:

- PC: To operate with Windows PCs with any Fanatec steering wheel*
- Comp V2.5: To operate with Windows PCs with any Fanatec steering wheel* in compatibility mode
- Xbox: To operate with Xbox One and Windows 10 PCs with any Xbox One licensed Fanatec steering wheel*

Usually the wheel base starts up in the last active operation mode with one exception: When attaching an Xbox One licensed steering wheel for the first time or after a firmware update the wheel base starts in Xbox One mode by default.

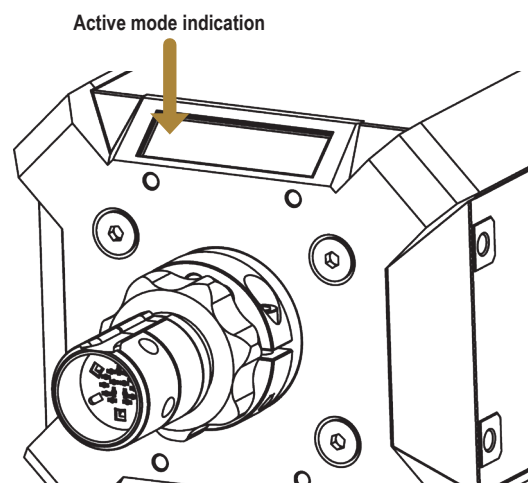

* optional and not included in this product package

BASE DISPLAY SCREENS

The OLED display of the Podium Wheel Base by default shows the Fanatec logo, detected peripherals, USB connection and operation mode.

Beyond that the display also can show alternative screens with different data, for example installed firmware versions, torque curves or device temperatures.

To switch the screens first press and hold the tuning menu button of the attached steering wheel and then navigate through the screens by FunkySwitch™ directions. Refer to the user manual for more details about the screens and also to the individual quick guides of the steering wheels for the tuning menu button and FunkySwitch™.

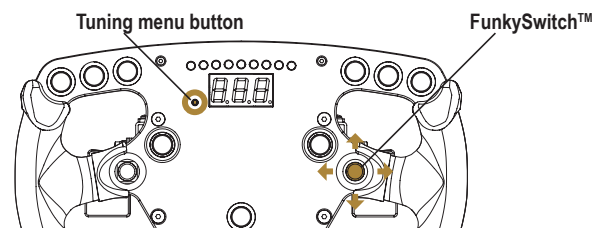

FUNKY SWITCH™	DISPLAY	MENU TITLE
		Default Screen
← →		Force Feedback Analysis
← →		Motor Data Analysis
← →		Temperature Analysis
↑ ↓		System Info