

# FANATEC®

## CLUBSPORT DD WHEEL BASE



**EN** Quick Guide  
**FR** Guide De Démarrage Rapide  
**DE** Kurzanleitung  
**ES** Guía Rápida  
**IT** Guida Rapida  
**PT** Guia Rápido



Rev. 04

### A PACKAGE CONTENTS

FR Contenu de l'emballage; DE Lieferumfang; ES Contenido del embalaje;  
IT Contenuto della confezione; PT Conteúdo da embalagem

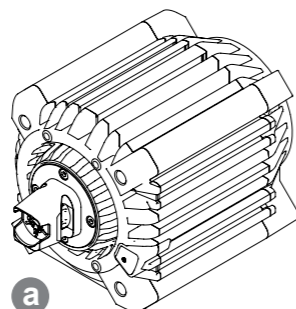

**a** 1x ClubSport DD Wheel Base

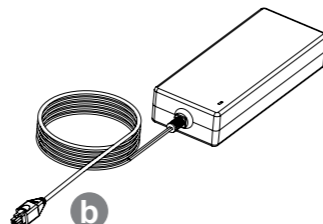

**b** 1x PSU  
(~ 140 cm)

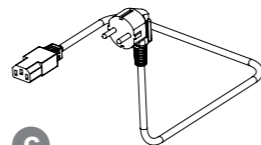

**c** EN 1x Power Cord (Regional)  
FR 1x Cordon d'alimentation (Régionale)  
DE 1x Netzkabel (Regional)  
ES 1x Cable de alimentación (Regional)  
IT 1x Cavo di alimentazione (Regionale)  
PT 1x Cabo de Alimentação (Regional)  
(~ 160 cm)

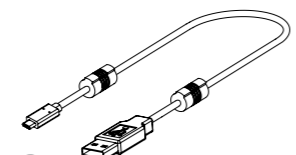

**d** EN 1x USB Type-A to Type-C Cable  
FR 1x Câble USB de type A vers type C  
DE 1x USB-Kabel Typ A zu Typ C  
ES 1x Cable USB tipo A a tipo C  
IT 1x Cavo USB da tipo A a tipo C  
PT 1x Cabo USB tipo A para tipo C  
(~ 290 cm)



**e** EN 4x T-Nut  
FR 4x Écrous en T  
DE 4x Nutenstein  
ES 4x Tuercas en T  
IT 4x Dadi a T  
PT 4x Porca T  
(M6x8 mm)

### B GETTING STARTED

FR Pour commencer; DE Erste Schritte; ES Cómo comenzar; IT Come iniziare; PT Começando



VIDEO  
MANUAL



Fanatec.com/QR/CS-DD



Fanatec.com/app



Fanatec.com/driver

1

### C PASSIVE COOLING

FR Refroidissement passif; DE Passive Kühlung; ES Refrigeración pasiva; IT Raffreddamento passivo;  
PT Refrigeração passiva

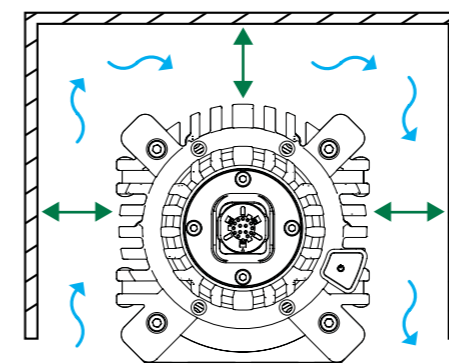
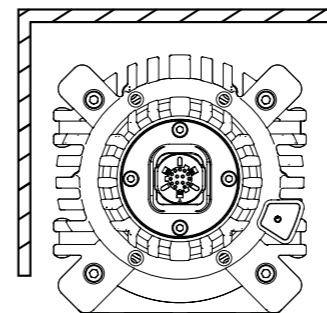

2

### D HARD-MOUNT

FR Installation fixe; DE Montage; ES Montaje; IT Montaggio; PT Montagem

EN Bottom; FR Sous; DE Unterseite  
ES Fondo; IT Parte inferiore; PT Fundo

EN Side; FR Côté; DE Seite  
ES Lado; IT Lato; PT Lado

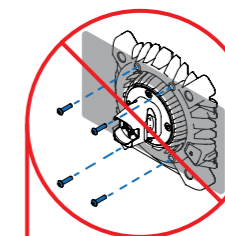
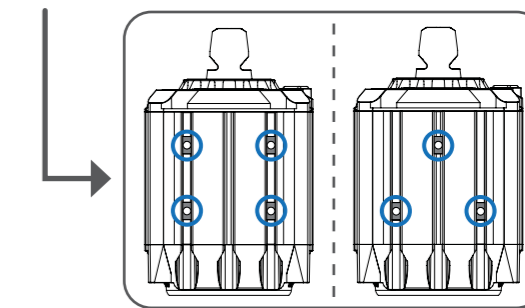
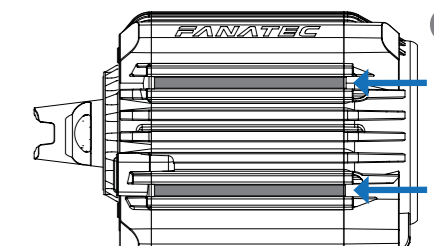
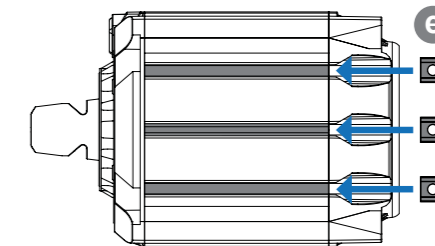

**EN** Not for hard-mounting the wheel base!  
**FR** Pas pour monter la base du volant!  
**DE** Nicht zur Wheel Base-Montage geeignet!  
**ES** ¡No para montaje de la base de volante!  
**IT** Non per montare la base del volante!  
**PT** Não para montagem na base do volante!

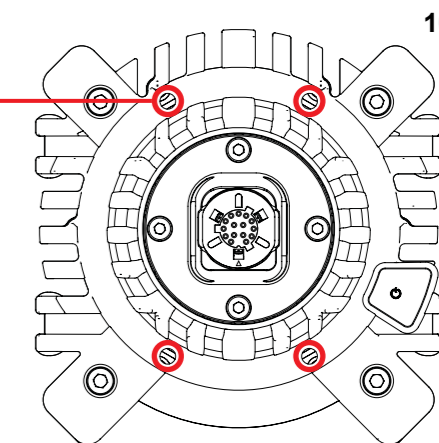

10 mm  
X mm

M6x(10+X) mm

3

# E CONNECTIONS

FR Raccordements; DE Anschlüsse; ES Conexiones; IT Connessioni; PT Ligações

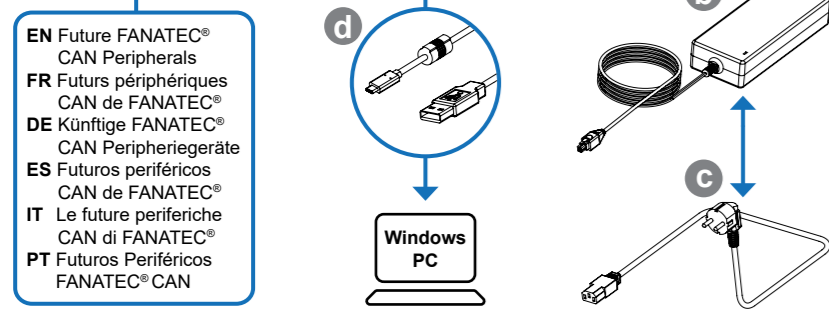
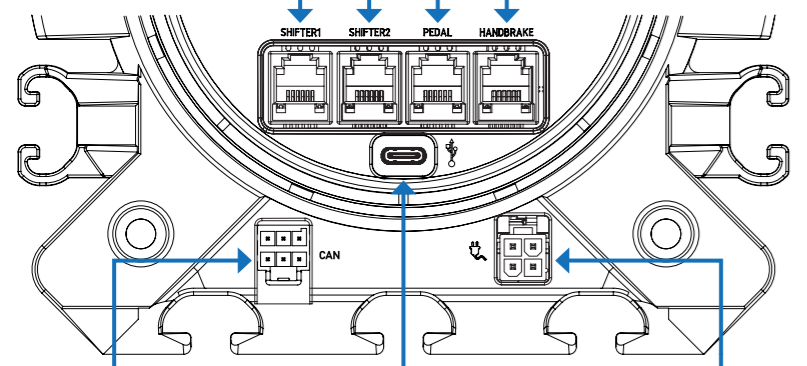
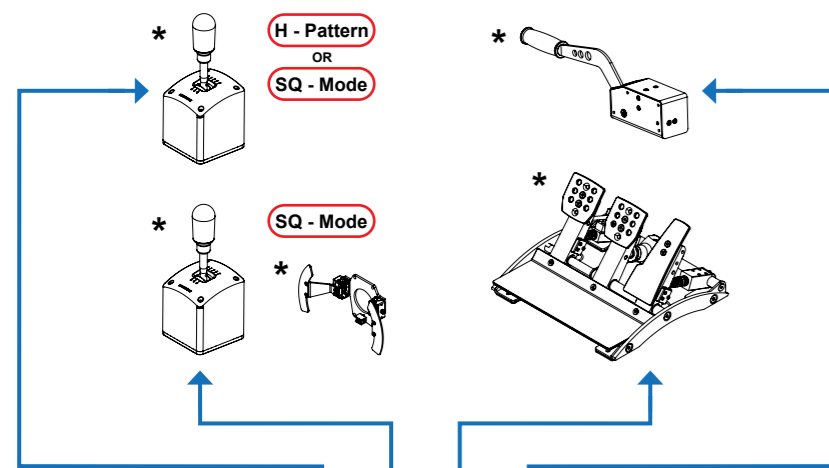

\* EN Sold separately; FR Vendu séparément; DE Separat erhältlich; ES Se vende por separado; IT Venduto separatamente; PT Vendido separadamente

# F ON & OFF

FR Marche et arrêt; DE An und Aus; ES Encendido y apagado; IT Accensione e spegnimento; PT Ligado e desligado

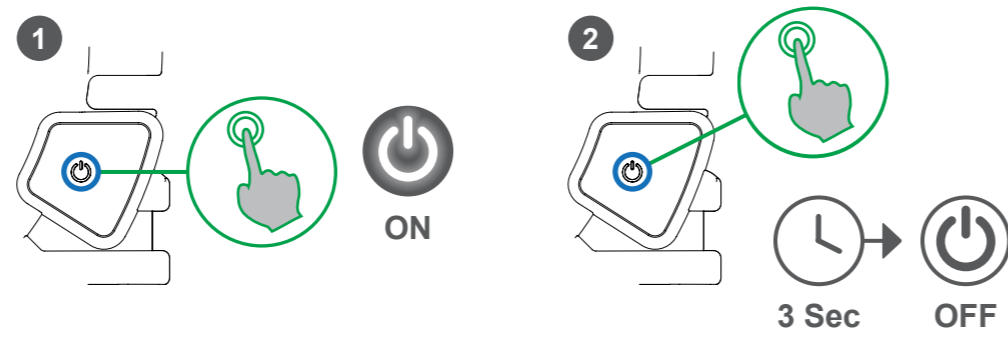

# G MODES

FR Modes; ES Modos; IT Modalità; PT Modos DE Modi

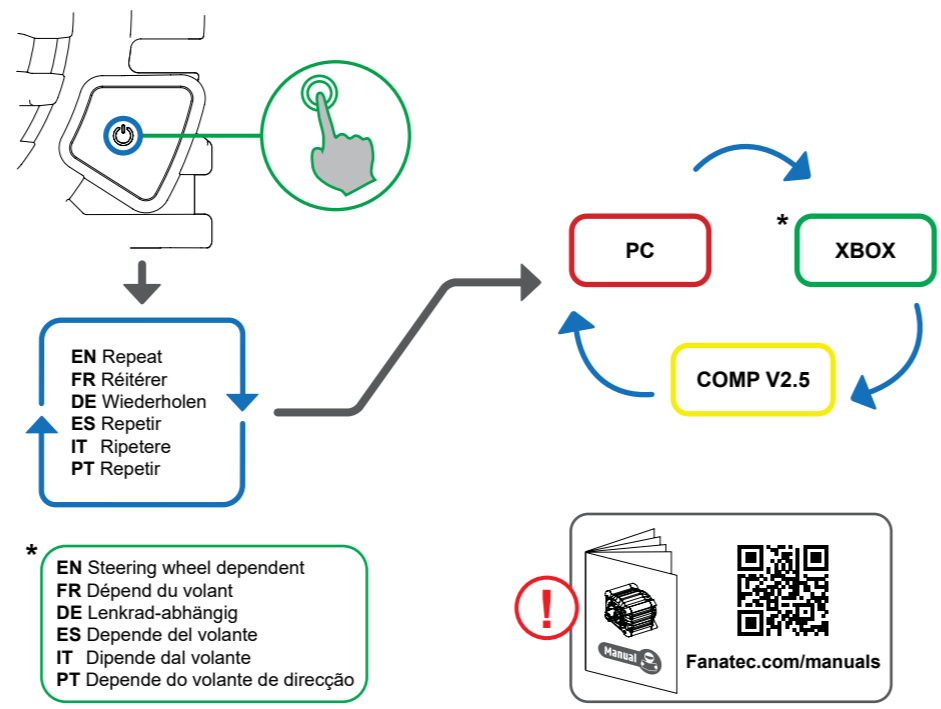

# H FIRMWARE UPDATE

FR Mise à jour du firmware; DE Aktualisierung der Firmware; ES Actualización del firmware; IT Aggiornamento del firmware; PT Atualização de Firmware

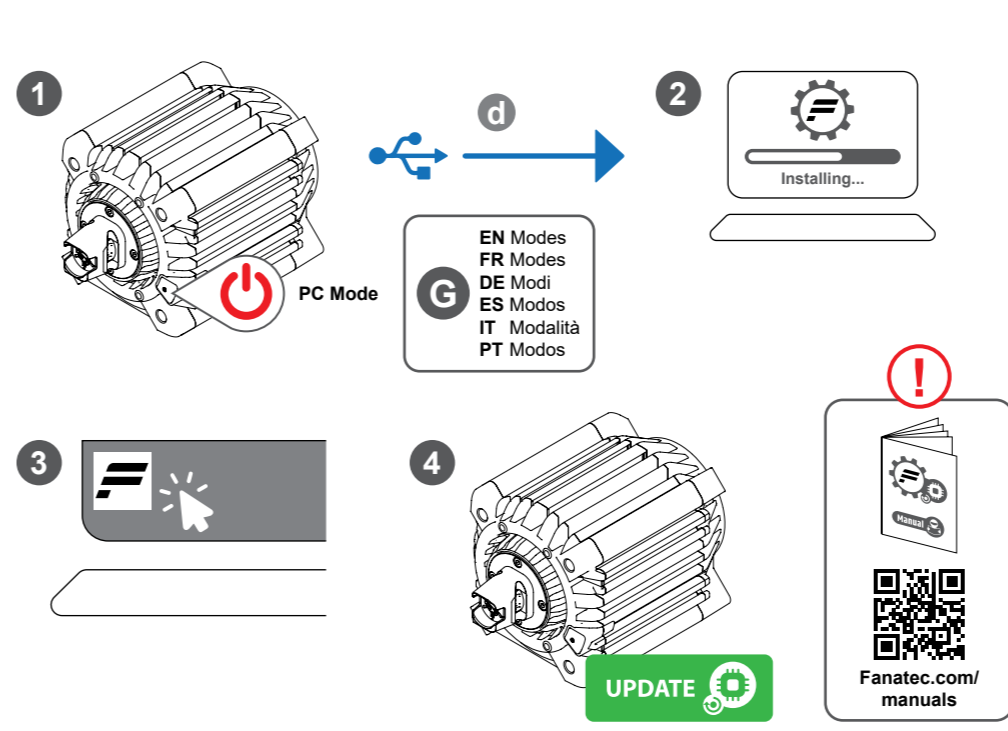

# I SUPPORT

FR Support technique; DE Unterstützung; ES Soporte técnico; IT Supporto tecnico; PT Suporte técnico

VIDEO MANUAL: [Fanatec.com/QR/CS-DD](http://Fanatec.com/QR/CS-DD)

APP: [Fanatec.com/app](http://Fanatec.com/app)

SUPPORT FAQ: [Fanatec.com/support/faq](http://Fanatec.com/support/faq)

EN The product warranty is provided by Endor AG. Refer to the included warranty sheet as well as the terms & conditions of Endor AG on fanatec.com.  
 FR Ce produit est sous la garantie d'Endor AG. Reportez-vous aux fiches de garantie incluses ainsi qu'aux conditions générales d'Endor AG sur fanatec.com.  
 DE Dieses Produkt unterliegt der Garantie der Endor AG. Beachten Sie die beiliegenden Garantieblätter sowie die Allgemeinen Geschäftsbedingungen der Endor AG auf fanatec.com.  
 ES Este producto está bajo garantía de Endor AG. Consulte las hojas de garantía incluidas, así como los términos y condiciones de Endor AG en fanatec.com.  
 IT Questo prodotto è coperto dalla garanzia di Endor AG. Fare riferimento ai fogli di garanzia inclusi nonché ai termini e condizioni di Endor AG su fanatec.com.  
 PT Este produto está sob garantia da Endor AG. Consulte as folhas de garantia incluídas, bem como os termos e condições da Endor AG em fanatec.com.

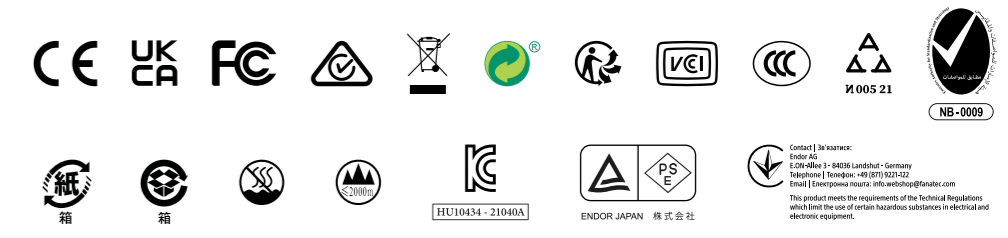

This device complies with part 15 of the FCC rules. The operation of this device is subject to the following two conditions:  
 • This device may not cause harmful interference, and must accept any interference received, including interference that may cause undesired operation.  
 • This device was not modified differently than described explicitly in this user manual.

NOTE: This device was tested and approved to the limitations for class B of digital devices according to part 15 of the FCC rules. This limitation should ensure an adequate protection against harmful interferences in residential areas. However, a warranty for the non-recurring of interferences is not assumed.  
 Do not modify the device differently than explicitly described in the product-related user manual. Nevertheless, if you do modify the device differently than explicitly described in the product-related manual, you can be determined to stop the operation of the device.

China RoHS 2  
 China RoHS 2 refers to the Ministry of Industry and Information Technology Order No. 32, effective July 1, 2016, titled Management Methods for the Restriction of the Use of Hazardous Substances in Electrical and Electronic Products. To comply with China RoHS 2, we determined this product's Environmental Protection Use Period (EUP) to be 10 years in accordance with the Marking for the Restricted Use of Hazardous Substances in Electronic and Electrical Products, SJ/T 11364-2014.

中国 RoHS 2 是指 2016 年 7 月 1 日起执行的工业和信息化部令第 32 号“电子电气产品有害物质限制使用有害物质管理办法”。为了符合中国 RoHS 2 的要求，我们根据“电子电气产品有害物质限制使用标识”(SJ/T 11364-2014) 确定本产品的环保使用期 (EUP) 为 10 年。

Importers:  
 Imported and distributed by Endor America LLC  
 8200 Wilshire Blvd, Suite 200 - Beverly Hills CA 90211 - USA  
 Telephone: +1 321-655-3524  
 Email: [webshop@fanatec.com](mailto:webshop@fanatec.com)  
 Website: [www.fanatec.com](http://www.fanatec.com) - [www.endor.ag](http://www.endor.ag)

Endor Australia Pty Ltd  
 3 Staley Street, California Gully, Vic, 3556 - Australia  
 Telephone: 661 453 979 40  
 Email: [webshop@fanatec.com](mailto:webshop@fanatec.com)  
 Website: [www.fanatec.com](http://www.fanatec.com) - [www.endor.ag](http://www.endor.ag)

Endor Japan Kabushikigaisya  
 E5001 3-13-1, Harumi Cyuo-ku Tokyo-to  
 Tokyo 104-0053 - Japan  
 Telephone: 03-6717-2719  
 Email: [webshop@fanatec.com](mailto:webshop@fanatec.com)  
 Website: [www.fanatec.com](http://www.fanatec.com) - [www.endor.ag](http://www.endor.ag)

Endor America LLC  
 EU: 00800 0 FANATEC or +49 (871) 9221-122  
 US/CANADA: 011 800 0 FANATEC or +49 (871) 9221-122  
 AUSTRALIA: 0011 800 0 FANATEC or +49 (871) 9221-122  
 JAPAN: +81 306 7172 719  
 Email: [info.webshop@fanatec.com](mailto:info.webshop@fanatec.com)  
 Website: [www.fanatec.com](http://www.fanatec.com) - [www.endor.ag](http://www.endor.ag)  
 Made in China